

ZEELANDER

PRE-OWNED

“One does not buy a
Zeelander. *You collect it.*”

AMBASSADOR



Quiet the world,
time stands still,
a tranquil haven







Bringing together the finest materials, cutting-edge technologies and the unrivalled expertise of our designers and craftspeople, we work with you to create a Zeelander that is as unique as you are. We'll source the best materials, colours and fabrics and master the techniques needed to make your vision a reality.



Timeless design,
contemporary soul







LOA

66' 7"



SPEED

40 *kt*



SOUND

< 72 *dBA*



Vessel's *particulars*

| | | | | | |
|----------------------------------|-------------------------|----------------|---------------------------|---------------------------------------------------|--------------------|
| BUILDER | <i>Zeelander Yachts</i> | | EMPTY WEIGHT | <i>42,0 t</i> | <i>92,600 lbs</i> |
| DESIGN | <i>Cor D. Rover</i> | | WEIGHT HALF LOAD | <i>47,5 t</i> | <i>104,790 lbs</i> |
| ENGINEERING & NAVAL ARCHITECTURE | <i>Sea Level</i> | | WEIGHT FULL LOAD | <i>53,1 t</i> | <i>116,980 lbs</i> |
| CONSTRUCTION | <i>GRP Composite</i> | | GENERATOR | <i>1x 21,5 kW / 60 Hz + 1x 13,5 kW / 60 Hz</i> | |
| MODEL YEAR | <i>2022</i> | | ENGINES | <i>Triple Volvo Penta D13-IPS 1350</i> | |
| LOCATION | <i>Florida</i> | | ENGINE HOURS | <i>330 H</i> | |
| LOA (PLATFORM CLOSED) | <i>20,3 m</i> | <i>66' 7"</i> | CRUISING SPEED | <i>32 kt</i> | |
| LOA (PLATFORM OPEN) | <i>22,2 m</i> | <i>72' 10"</i> | MAXIMUM SPEED | <i>40+ kt</i> | |
| BEAM | <i>6,0 m</i> | <i>19' 8"</i> | RANGE AT 7 KT | <i>3.050 nm</i> | |
| DRAFT | <i>1,5 m</i> | <i>4' 11"</i> | RANGE AT 26 KT | <i>610 nm</i> | |
| AIRDRAFT | <i>5,1 m</i> | <i>16' 9"</i> | FUEL CONSUMPTION AT 26 KT | <i>255 l/h</i> | <i>70 gal/h</i> |
| DESIGN CATEGORY | <i>CE-A</i> | | FUEL CAPACITY | <i>6.000 l</i> | <i>1.590 gal</i> |
| CREW LIMIT | <i>12</i> | | FRESH WATER CAPACITY | <i>1500 l</i> | <i>400 gal</i> |
| | | | BLACK WATER CAPACITY | <i>400 l</i> | <i>110 gal</i> |
| | | | BOILER | <i>160 l</i> | <i>40 gal</i> |
| | | | BERTHS | <i>6 + 1 crew</i> | |
| | | | BATHROOM CABINS | <i>3 + 1 crew</i> | |
| | | | TENDER GARAGE | <i>Yes, Williams 345 Turbojet tender included</i> | |
| | | | SOUND | <i>< 72 dBA</i> | |

General *arrangements*

Top view

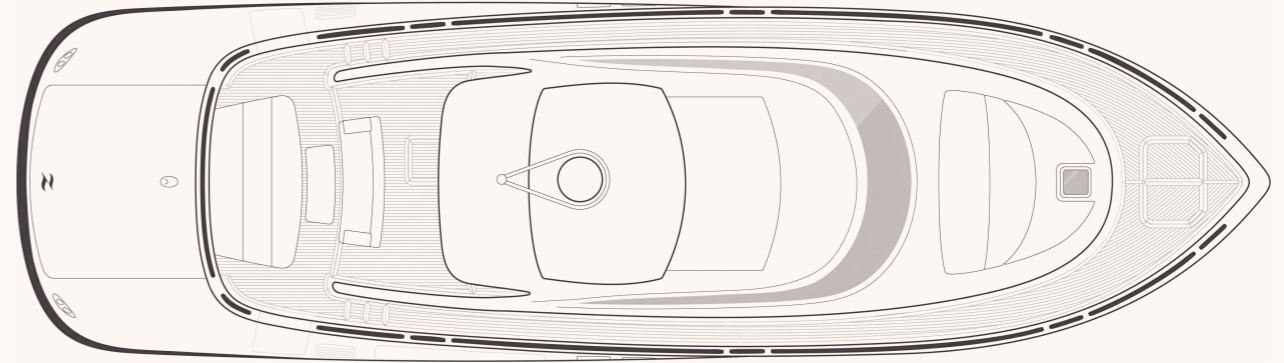

*Main deck with
swim platform open*

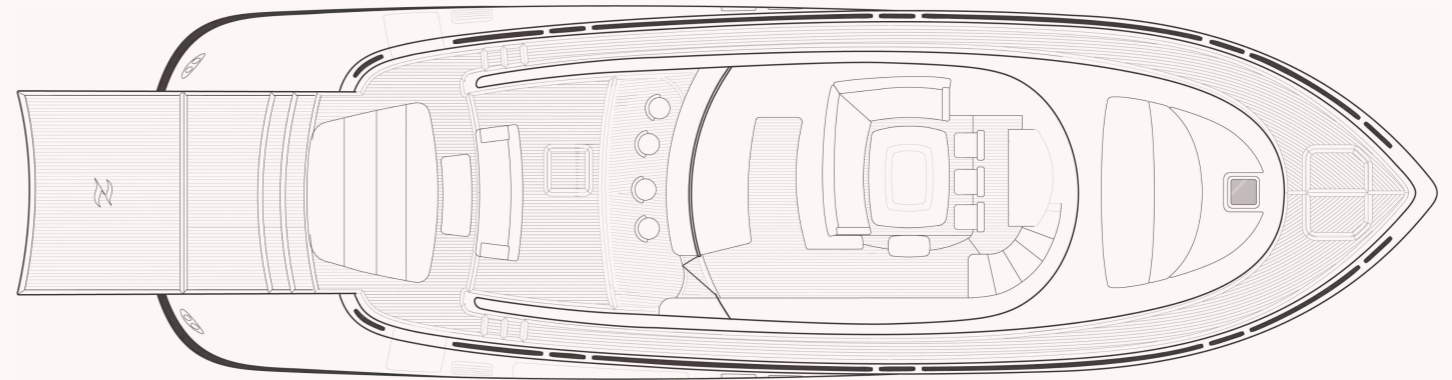

Lower deck

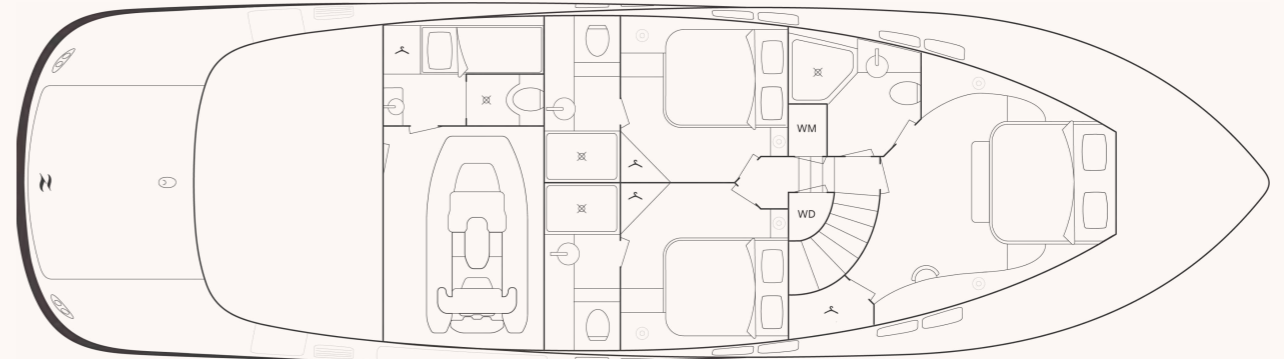











Bringing together the finest materials, cutting-edge technologies and the unrivalled expertise of our designers and craftspeople, we work with you to create a Zeelander that is as unique as you are. We'll source the best materials, colours and fabrics and master the techniques needed to make your vision a reality



Sales *contacts*

Menno Versluis

Sales Director

menno.versluis@zeelander.com

+31 6 51 13 98 05

John Slate

US Sales Representative

john.slate@zeelander.com

+1 (954) 815-2287

Disclaimers:

All performance data, including speeds, fuel consumption and range, are estimated at half-load at the time of testing and cannot be guaranteed. Actual performance may vary. Boat performance may be impacted by many factors including, but not limited to, loaded displacement, boat configuration and options, trim, sea conditions, climate, hull bottom, surface condition and mechanical systems condition.

Specifications are subject to change without notice, except where this document is already part of a mutually signed purchase agreement between Buyer and Zeelander, in which case Zeelander reserves the right to change these specifications with Buyer's prior written consent.



ZEELANDER

